



2013 Mast Range

PLATINUM.AERO

Light, lighter, the lightest!

Back in 2002 this was already the case with the design study VIPER AERO. Back then it showed the limits of feasibility. Weighing in at less than one kilo this mast still holds the world record. Unfortunately, this limited production series was suitable only for flat-water use. With the radical PLATINUM AERO 2013 we introduce a dignified ultra-light successor that is much more advanced than the former design study. By processing the revolutionary, ultra lightweight D4.SHIELD this mast achieves minimum weight combined with unexpected durability. In concrete: laboratory tests prove that 85% of the fractional values of a regular PLATINUM mast are achieved! An absolutely sensational result, which is why the new PLATINUM AERO is not only the lightest, but definitely also most durable mast in its class!

Less is more, and lighter is impossible.

The PLATINUM AERO is ultimately the lightest 100% carbon mast in the world documenting our leadership position in the mast construction.

With only just over a kilo many will question the durability, but that is exactly the unbelievable! By processing the revolutionary, ultra lightweight D4.SHIELD we achieve not only this sensational weight but also in addition incredible durability values. In concrete 85% of the durability of the regular PLATINUM! An absolutely sensational result, which is why the new PLATINUM AERO is not only the lightest, but definitely also most durable mast in its class!

The lengths 370 up to 430cm are freestyle/wave-oriented RDM masts, while the longer lengths come as freeride-oriented SDM masts.



Get your 2013 product & action pictures on our NorthSails Extranet: <http://northwindsurf.fluxiom.com/user/login>

2013 Mast Range

The mast program in 2013 comes up with new detail and quality improvements, particularly regarding the refined breakage strength.

New for 2013:

ALUTEX.SHIELD

Introduced in 2001 the ALUTEX winding gives even 100% carbon masts an unmatched durability. That's why the PLATINUM is and remains the most durable mast in its class. We are so convinced about the superior durability-values of the new PLATINUM masts that as the first brand ever we offer a 2.YEAR.UNCONDITIONAL.WARRANTY* on a 100% carbon mast.

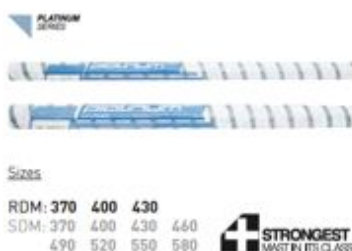
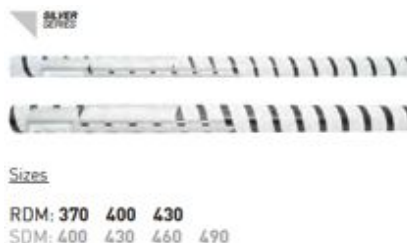

Get your 2013 product & action pictures on our NorthSails Extranet: <http://northwindsurf.fluxiom.com/user/login>



CARBON FIBER QUALITIES

THE essential quality criterion of carbon fibers when used for Windsurf masts is the bending-elongation of the fiber. The elongation measures the traction during bending until the fiber finally breaks.

For a Windsurf mast this means: the higher the bending-elongation value of the carbon fiber raw material

- the faster the reflex speed (which ultimately increases the performance of your sail, similar to increased horse power in a car)
- the higher the breakage strength

Carbon fibers are available with bending-elongation values between T300 and up to max T1000 with the T1000 carbon being 10-times as expensive as cheap T300 carbon. The lowest quality carbon fibers used on Windsurf masts have an elongation value of T300-400. This carbon has a bending-elongation which is just slightly higher than glass fiber. Therefore it's used on cheap "low-percentage carbon masts" only. 80% of all brands nowadays use T400-500 for their top level carbon masts.

NorthSails CARBON FIBER QUALITIES

Red Series: T600

Silver Series: T600

Gold Series: T700

Platinum Series: T700

Platinum Aero: T800 with 30% reduced resin content

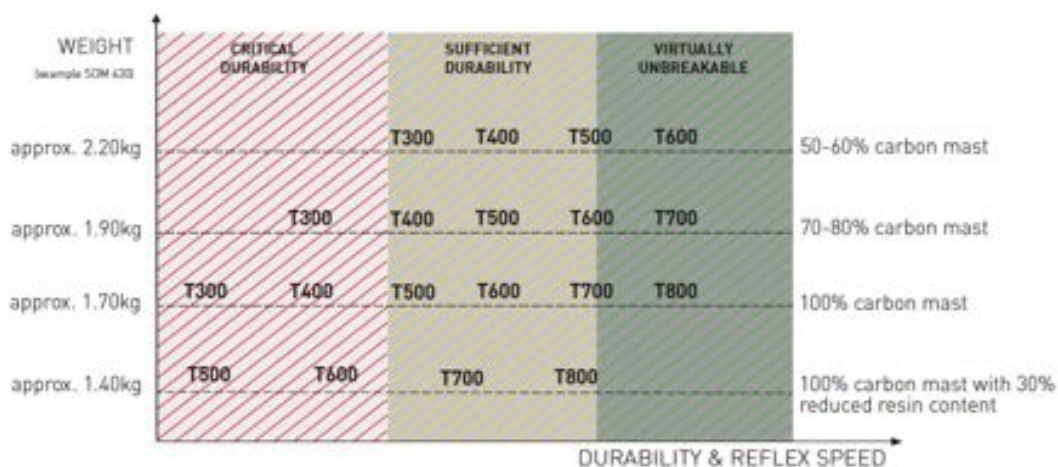

Get your 2013 product & action pictures on our NorthSails Extranet: <http://northwindsurf.fluxiom.com/user/login>

2013 Extension Range

UNI.XT SERIES

FEATURES:

1. Compatible with all sail brands

The unique arrangement of the rollers ensures an absolutely frictionless alignment of the downhaul rope in combination with 0° sail roller blocks (eg, North Sails, NeilPryde, Gaastra, ...) as well as with 90° rotated roller units (eg, Gun Sails, Naish, Severne). This saves power by reducing the friction and protects the rope. At the same time this arrangement for the first time allows the first loop-loop-go function with absolutely all sail brands! Means no annoying and time-consuming threading through the rollers - simply loop the rope-loop over the two outer tack rollers and you can immediately start downhauling

2. SHOX.UPGRADE.KIT

for advanced suspension technology Certainly the killer feature of the sophisticated UNI.XT is the possibility to expand it with the revolutionary and absolutely unique NorthSails SHOX suspension system.

The upgrade is easily done in a few simple steps.

Of course the SHOX.UPGRADE.KIT is available for both UNI.XT SDM and RDM in all lengths!

3. DOUBLE.FOOT.TRIM: Power-saving, less dangerous trimming!

In terms of rigging comfort the new UNI.XT offers much more than existing standard extensions. In order to ensure the most effective tensioning of the downhaul we have designed the cup under ergonomic points of view incorporating the DOUBLE.FOOT.TRIM. Through the intelligent positioning of the cleat, it is now possible to prop with both feet against the cup, and thus cope far greater forces with lower back strain.

4. Designed, developed and assembled in Germany

Highest quality materials and the anodized surface leave no doubt about the strength and durability of the extension.

The length adjustment mechanism is easy to operate even in sandy conditions and with cold fingers and is locked absolutely reliable. This means: zero risk of fracture, unbeatable rigidity and length adjustment as quickly as possible.



Get your 2013 product & action pictures on our NorthSails Extranet: <http://northwindsurf.fluxiom.com/user/login>

2013 Base Range

i.BASE SERIES

One for all, all in one!

A completely new, universal mast base system. The top priority in addition to the functionality was a requirement to create ONE single, uncompromising system for ALL conditions. The result is the iBASE, the lowest mast base system with central screw!

A highly functional base with an extremely low profile, is lightweight but virtually indestructible and provides numerous benefits in handling and tuning options.

FEATURES

1. One for all - just one base for all conditions

We are 100% convinced that absolutely everyone in all conditions and for all disciplines needs only one base. The flexibility and ease of de/ attaching makes the need for different bases and systems simply obsolete. That is why from now we offer the iBASE only.

2. Low profile, extreme durability

To guarantee that the new iBASE can be attached and detached without any tools in seconds, it was deliberately designed with a central screw. Although these solutions usually require a relatively high

profile, our engineers have found a solution, so it became the lowest base of its kind. Since there is nothing in the way, the risk of injury to feet and toes is as small as possible. In contrast to conventional mast feet, which are made of Zytel plastic, the new iBASE is the only one produced using the much stiffer material called POM, which improves the durability.

3. Release option

We have always been annoyed having to unscrew the base from the board after the surf session with tired hands, just so the board fits into the board bag. And: Why do you have to unscrew the joint from the base when changing the joint? Both annoyances are a thing of the past with the new iBASE. It features a convenient sand-resistant release option, which allows to remove the connection joint by simply pulling the stainless steel U-wire.

4. Free choice of the connection joint

From now on you can choose from three new, super high quality connection joints that are a slightly softer or stiffer just as you prefer.



Get your 2013 product & action pictures on our NorthSails Extranet: <http://northwindsurf.fluxiom.com/user/login>

2013 Base Range

i.BASE SERIES

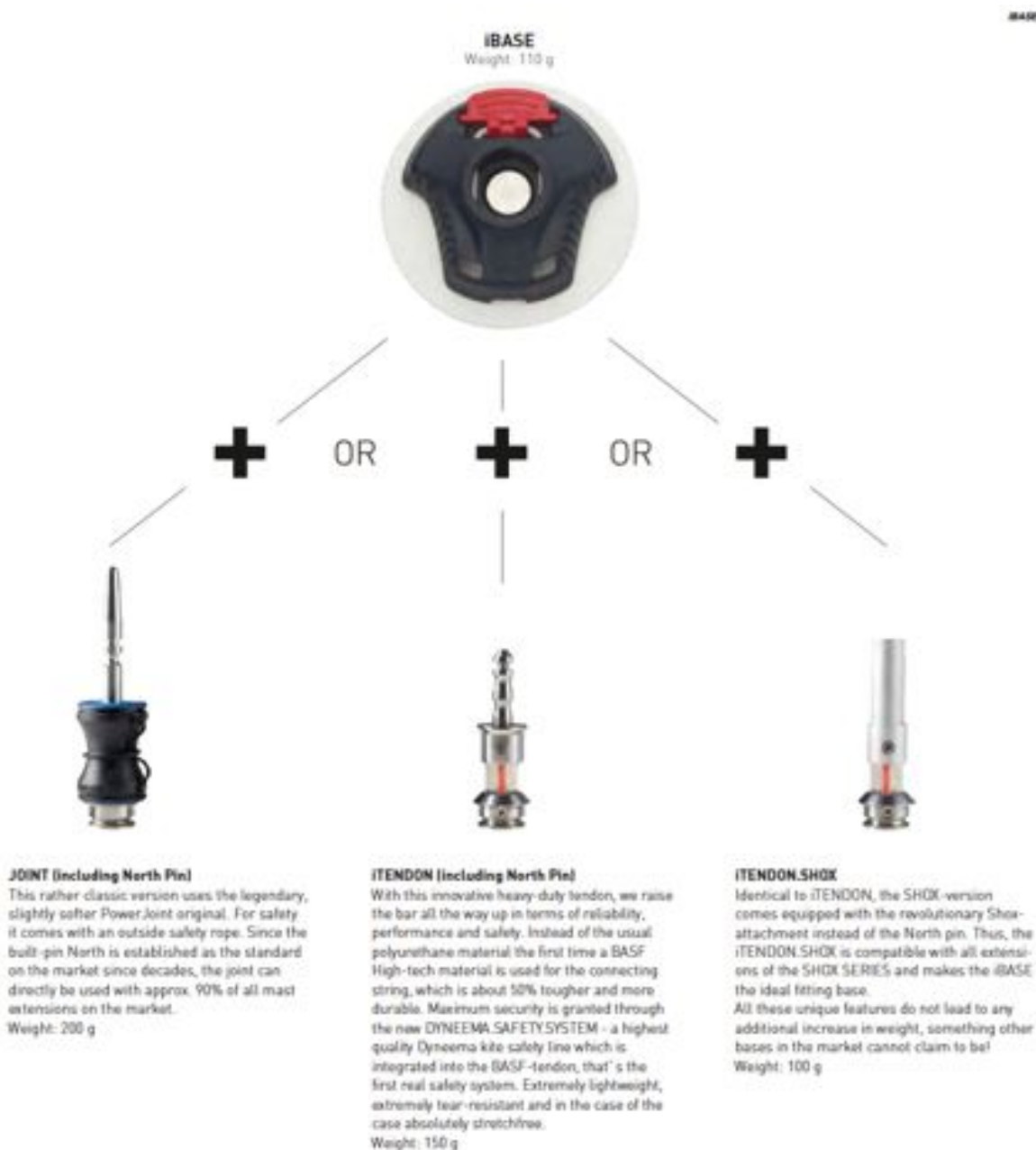

Get your 2013 product & action pictures on our NorthSails Extranet: <http://northwindsurf.fluxiom.com/user/login>

2013 Boom Range

New for 2013:

A completely new development is the radical, outside Race/Formula tail-ends that are the lightest on the market (PLATINUM 170, 190 and 240.)

The unique loop-loop-go function (patent pending) now available on PLATINUM and GOLD booms!



GOLD RS SERIES

RACING BENDCURVE
170-210 / 190-250



RED SERIES

NEW SCHOOL BENDCURVE
140-190 / 150-200

PROGRESSIVE BENDCURVE
140-190 / 150-200



PLATINUM SERIES

NEW SCHOOL BENDCURVE
140-190 / 150-200

RACING BENDCURVE
170-220 / 190-250 / 240-290



SILVER HD SERIES

NEW SCHOOL BENDCURVE
140-190 / 150-200 / 160-210

CLASSIC BENDCURVE
180-230 / 200-250



RED GROM

PROGRESSIVE BENDCURVE
90-120 / 120-170

Get your 2013 product & action pictures on our NorthSails Extranet: <http://northwindsurf.fluxiom.com/user/login>